

***TECTRIS®***

**FLEXIBLE.  
INNOVATIVE.  
CUSTOMISED.**



# THE TECTRIS SKIP LOADER

## DESIGNED FOR PRACTICAL USE!

MEILLER skip loaders are designed for ultimate productivity – from the very first day and throughout their entire service life. MEILLER stands for ultimate product quality and value retention. The high-quality workmanship is created using state-of-the-art processes and benefits from the use of high-strength materials. The frame construction is extremely stable and well protected against corrosion.





Cost-effective use of TECTRIS in the construction industry



... and in the waste and disposal sector.

#### TRANSPORTING ECONOMICALLY

TECTRIS® skip loaders let you transport container loaders efficiently and safely. Successfully proven in the construction and waste management industries and made for harsh practical conditions. The loading platform of the MEILLER skip loader comes without a vehicle-specific subframe. This results in a low tare weight and permits high payloads.

#### HYDRAULIC SYSTEM QUALITY

The high-quality MEILLER hydraulic system ensures fast and responsive work operations. This is complemented by precise and load-independent synchronisation of the stabilising legs and telescopic lifting arms – and all this with very low-noise operation.

#### LOAD-DEPENDENT QUICK MOVEMENT

The load-dependent quick movement accelerates the setting down and tipping and protects the hydraulic system. When skips are empty, quick movement operates over the entire stroke. When skips are laden, quick movement is only switched on in a specific uncritical range.

#### KTL IMMERSION PRIMING PROCESS

The KTL immersion priming process provides outstanding corrosion protection and consistent surface quality. Thanks to the complete and even coating – even in hard-to-reach areas – the treated surfaces remain resistant to scratches and stone chips.

# PRODUCT RANGE

## THE IDEAL TECTRIS® SKIP LOADER FOR EVERY REQUIREMENT

TYPE	AK7	AK10	AK14	AK18
Nominal load	7.4 t	11 t	14 t	18 t
Number of axles	2 axles	2 axles	2 axles	3 axles
Suitable chassis	9-12 t	12-15 t	up to 20 t	up to 28 t
AK weight	2,000-2,150 kg	2,070-2,220 kg	2,990-3,210 kg	3,120-4,060 kg
Skip type	<ul style="list-style-type: none"> <li>- DIN 30720 Part 1</li> <li>- DIN 30730-MAP-AKF</li> </ul>	<ul style="list-style-type: none"> <li>- DIN 30720 Parts 1 and 2</li> <li>- DIN 30730-MAP-AKF</li> </ul>	<ul style="list-style-type: none"> <li>- DIN 30720 Parts 1 and 2</li> <li>- DIN 30730-MAP-AKF</li> <li>- Silo container</li> </ul>	<ul style="list-style-type: none"> <li>- DIN 30720 Parts 1 and 2</li> <li>- DIN 30730-MAP-AKF</li> <li>- Silo container</li> </ul>
Supporting arm types	TG	TG	N, T, TG, Z, ZA	N, T, TG, Z, ZA

### ALWAYS THE MATCHING LIFTING ARM TYPE

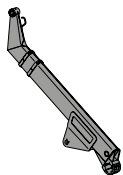

#### N lifting arm

- simple and sturdy
- optimal for skips that often have the same size

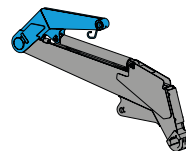

#### Z lifting arm

- for low heights during transport (e.g. when travelling through underpasses)

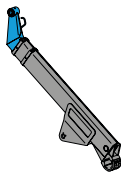

#### T lifting arm

- for high tipping
- for all skip sizes

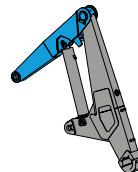

#### ZA lifting arm

- for low heights during operation (e.g. picking up skips in halls)

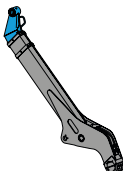

#### TG lifting arm

- with restricted space available
- optimum skip handling





Skip loader TECTRIS AK 14



The telescopic equipment achieves long reaches of almost 4.5 metres, e.g. for easy transfer of the skip in trailer operation.

# LOAD SECURING

## TRANSPORTING AND LOADING SKIP LOADERS SAFELY

### SKIP LOCK

MEILLER skip loaders provide you with reliable and appropriate skip securing. All MEILLER load securing modules can be operated with the i.s.a.r.-control radio control unit. The modular concept makes different combinations possible. All MEILLER skip loaders fulfil the requirements for load securing in accordance with

§ 22 and 23 of the German road traffic regulations StVO and § 30 StVZO in conjunction with VDI guideline 2700 and 2700 sheet 17 (verified by loading certificate from TÜV-Nord).



### STANDARD

Manually adjustable skip stops



### BKE - SKIP CLAMPING SYSTEM

Hydraulically operating skip stops that secure skips against slipping sideways.

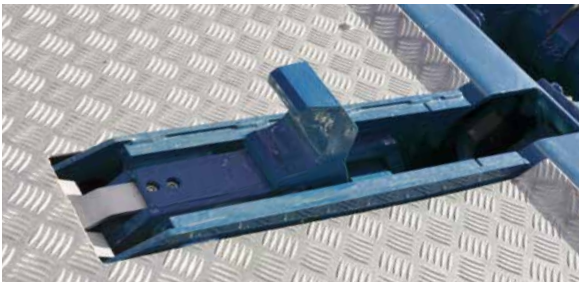

### CV - SKIP LOCK

Hydraulically operating hooks that actively engage in the skip pivot bearings and effectively secure the skip at the front and rear.

### SKIP LOCK VARIANTS

	Standard	BKE module	CV module	Comfort	Comfort Plus
At the side	manual	SCS	manual	SCS	SCS
At the front	manual	manual	SLS	manual	SLS
At the rear	skip support	skip support	SLS	SLS	SLS

## TARPAULIN SYSTEMS

The MEILLER tarpaulin system lets you secure your load in the skip easily and in accordance with regulations. The system is optimally matched to the MEILLER skip loader. This means you benefit from an integrated solution from a single source. Operation is simple and practical.



### TARPAULIN CAN BE PULLED UP IN APPROX. 20 SECONDS

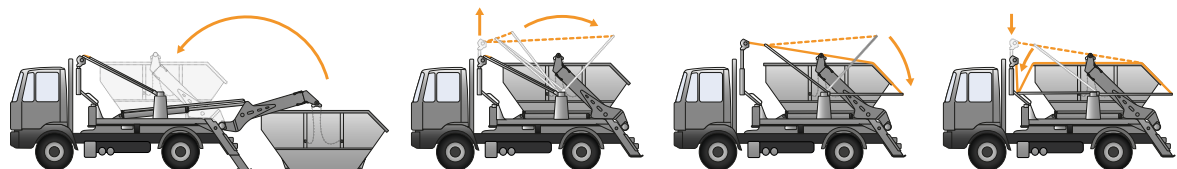

1. The skip is picked up and secured on the loading area.
2. The tarpaulin reel with drive motor is raised from the height-adjustable tower behind the cab.
3. The rear lifting rods guide the tarpaulin safely over the entire skip and secure it downwards.
4. The front tensioning rods pull the tarpaulin downwards and secure it against any wind forces.

# OPERATION

## SIMPLE AND CONVENIENT FOR ULTIMATE WORK SAFETY

You can use the i.s.a.r.-control remote control to load skips from a safe distance and at a location that provides the best visibility.

The pre-programmed sequences of the sequence control make it easy to operate at the touch of a button. This saves time and avoids errors in the sequence of operating steps. Up to 30 seconds can be saved per sequence.

### I.S.A.R.-CONTROL – YOUR ADVANTAGES

- Long radio coverage range
- For rugged use:
  - Can also be operated with gloves
  - Illuminated buttons for night operation
  - Integrated antenna
  - Circumferential rubber border
- Good handling:
  - Control elements arranged logically and clearly
  - One-hand operation possible
  - Low weight of approx. 340 g only
- Optimised power supply  
(Li-rechargeable battery without memory effect)
- Engine Start/Stop button centrally positioned
- Emergency stop button
- Retainer with magnetic holder

### THREE DIFFERENT PROGRAMME SEQUENCES ARE AVAILABLE:

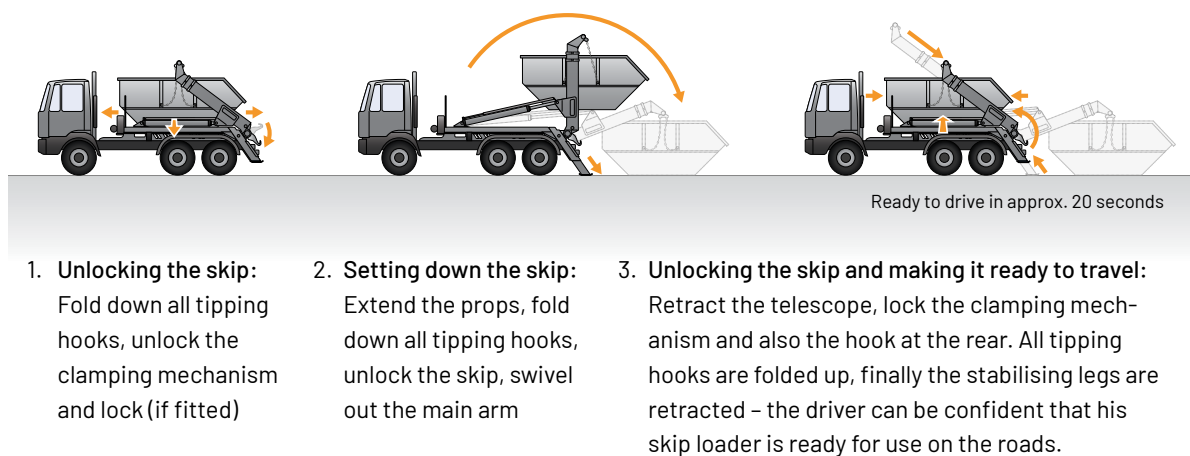



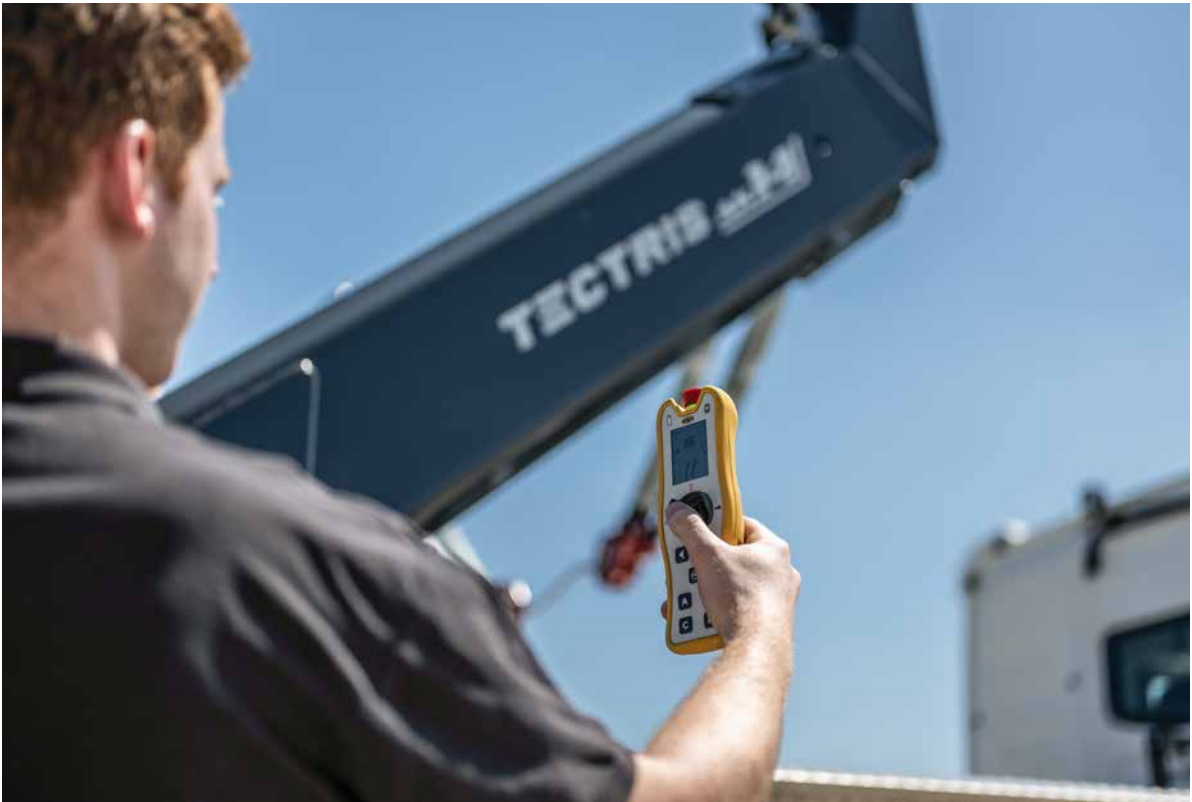

Always control your sequences quickly and safely with the practical i.s.a.r.-control remote control.



TECTRIS skip loader ready to drive.



MEILLER control unit with integrated overload indicator.

# FEATURES FOR PRACTICAL USE

## INNOVATIVE AND EFFICIENT IN EVERY DETAIL

### SAFE MEILLER TIPPING HOOKS

The robust tipping hooks allow you to empty the skip safely. The integrated safety catch protects the skip from overturning and slipping out when tipping.

### ADAPTING THE CHAIN LENGTH

Adjust your chain length with the MEILLER M fastener. The practical chain suspension at the upper ends of the telescopic arms makes it easy to shorten or lengthen the chain.

### ROBUST CONTROL UNIT

MEILLER skip loaders are equipped as standard with a control unit with overload indicator and emergency control. All control components are installed protected.

### LAMPS WITH LED TECHNOLOGY

LED lamps and camera system offer the best visibility in the work area and ensure road safety.



For further accessories,  
see [meiller.com](https://meiller.com)



#### HYDRAULIC SYSTEM QUALITY

- The original MEILLER hydraulic system is the heart of all MEILLER products – developed and manufactured in Munich.
- The hydraulic system made of high-quality materials ensures the minimum dead weight and best payloads with optimum cylinder sizes.
- The MEILLER hydraulic components are wear-resistant, dirt-resistant and practically maintenance-free.

#### STORAGE SPACE OPTIONS

- Large storage box behind the cab, also suitable for bulky tools, such as shovels and brushes, with lockable lid.
- Storage boxes for small parts at the rear, with lockable lid
- Side tool box
- Side extendable net boxes

#### ACCESS STEPS

- Side access steps are BG-compliant (German Employers' Liability Insurance Association)
- Access step at the rear on one or both sides, with hand rail on the lifting arm, three offset steps

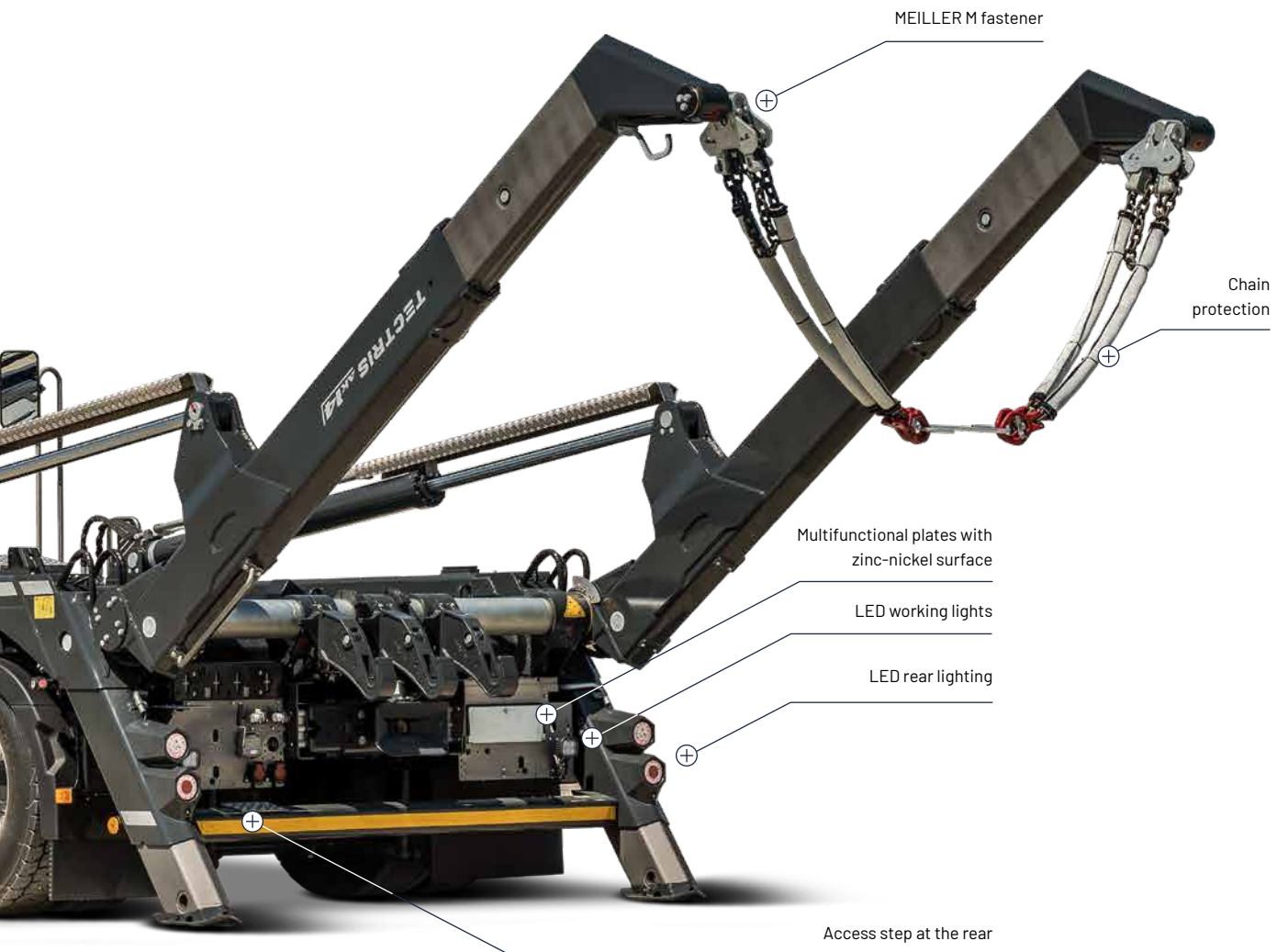

# QUALITY AT MEILLER

## WHAT DOES QUALITY MEAN TO US?

For more than 170 years, the name MEILLER has stood for the highest product quality and outstanding innovative energy. Our aim is to provide you with reliable and durable products that can withstand even the harshest conditions.

### DEVELOPMENT QUALITY

MEILLER is known for outstanding quality in the development phase. Our design engineers develop solutions to meet customer requirements. Advanced endurance tests, long-term trials and intensive salt spray tests are an integral part of our development process and ensure the excellent quality of our products. Customer proximity is important to us: we actively involve our customers in the development process and in practical field tests. Our aim: to develop the best tool for your application. Continuous material testing and process monitoring ensure the quality of the products after the development phase.

### HYDRAULIC SYSTEM QUALITY

The hydraulic systems from MEILLER, developed and manufactured in Munich, form the core of our products. They are made of high-quality materials and are designed to enable the best payloads with minimal tare weight. Thanks to optimum cylinder sizes and wear-resistant, dirt-resistant components, our hydraulic systems are practically maintenance-free and contribute decisively towards the longevity and efficiency of your vehicle.

### PRODUCT QUALITY

The high quality of our products is the result of decades of experience and constant improvement. Our surface concept promotes the highest level of corrosion protection. The basis is a cathodic dip coating or a wet primer with a subsequent top coat. In addition, body-cavity sealing and bolted mounting are carried out on components that have already received a surface treatment. The durable MEILLER hydraulic system, combined with high-strength steel and floor plates made of at least HBW 450 steel, guarantee the characteristic MEILLER robustness and high resale value.

### SERVICE QUALITY

Our experienced and competent service team works continuously to minimise your downtime. An extensive service network, a mobile after-sales service and customer service centres around the world ensure that you receive help quickly and reliably. Our sophisticated logistics enable us to deliver original parts to the required location as quickly as possible. This ensures that your MEILLER product is always ready for use.

1 Development quality

2 Service quality

3 Product quality

4 Hydraulic system quality







# MEILLER TIPPER

ECONOMIC. RELIABLE. INNOVATIVE.

## COMPANY

MEILLER stands for durable, practical and technically sophisticated tipper superstructures that can be adapted to individual requirements with many options.

MEILLER employees work every day to make the products safer to use, practical and convenient to use in practice.

MEILLER relies on state-of-the-art manufacturing processes throughout the entire process chain and continuously optimises product development in order to always keep one step ahead of increasing quality standards.

Steel components, hydraulic systems and control technology come from a single source at MEILLER – the unique compatibility of the components speaks for the efficiency of the MEILLER products and their long lifetime.

EVERY MEILLER EMPLOYEE  
IS A GUARANTEE FOR THE HIGH QUALITY OF ALL MEILLER PRODUCTS.





### SUSTAINABLE INTO THE FUTURE

Certified environmental management in accordance with DIN 14001:2015 and EMAS demonstrates that MEILLER is committed to the responsible and efficient use of resources.





You don't want to miss anything?  
Subscribe to our newsletter!

F.X. MEILLER Fahrzeug- und Maschinenfabrik GmbH & Co KG  
Ambossstraße 4 | 80997 Munich | Germany  
T +49 89 1487-0 | [info@meiller.com](mailto:info@meiller.com) | [meiller.com](http://meiller.com)

1609\_En-731-0325

Subject to technical modifications and errors.  
Illustrations may show special equipment.